

Furzehill Square, Orpington, BR5

3 Bedroom Semi-Detached House For Sale

Offers In The Region Of £525,000





A Truly Fabulous Three Bedroom Family Home in a Prime Location

This beautifully presented three-bedroom semi-detached house, offered in immaculate condition throughout. Boasting front and rear gardens together with a private driveway providing off-street parking for two cars. This superb property is perfectly suited to commuters, families, first-time buyers and it also offers an attractive buy-to-let investment opportunity, with rental potential.

The property comprises an entrance hallway, downstairs WC, spacious lounge, and an open-plan kitchen/dining room with direct access to the rear garden. The garden also benefits from side access to the front driveway. Upstairs, there are three bedrooms and a family bathroom, providing well-proportioned accommodation.



Situated in a highly sought-after residential location, the property benefits from excellent transport connections, with St Mary Cray Station just a short walk away, offering convenient services into Central London. A variety of local shops, supermarkets, including Nugent Shopping Park, schools and everyday amenities are all within easy reach, making this an ideal location.



Key Features

- Three bedrooms
- Spacious lounge
- Downstairs WC
- Modern open plan kitchen/ dining room
- Contemporary family bathroom
- Front and rear gardens
- Driveway parking for two cars
- Well presented throughout
- Excellent location close to St Mary Cray Station



Additional Highlights

- Freehold tenure
- EPC Rating: C
- Council Tax Band: D

Viewing is highly recommended to fully appreciate all that this wonderful home has to offer.





Energy Efficiency Rating

	Current	Potential
Very energy efficient - lower running costs		
(92 plus) A		
(81-91) B		89
(69-80) C	76	
(55-68) D		
(39-54) E		
(21-38) F		
(1-20) G		
Not energy efficient - higher running costs		
England & Wales	EU Directive 2002/91/EC	

Approx Gross Internal Area
70 sq m / 758 sq ft

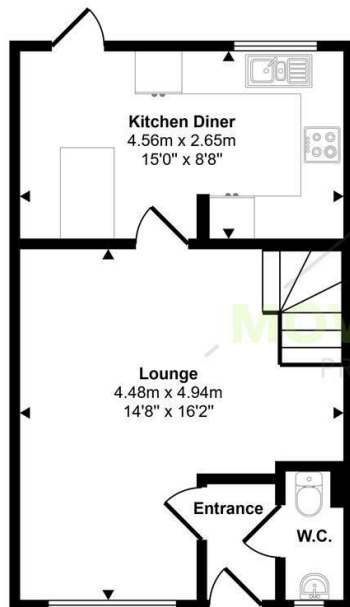

Ground Floor
Approx 35 sq m / 380 sq ft

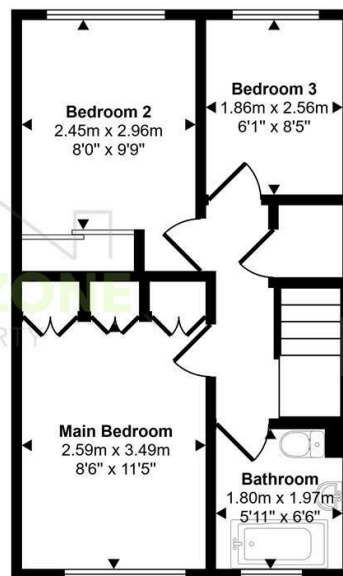

First Floor
Approx 35 sq m / 378 sq ft

This floorplan is only for illustrative purposes and is not to scale. Measurements of rooms, doors, windows, and any items are approximate and no responsibility is taken for any error, omission or mis-statement. Icons of items such as bathroom suites are representations only and may not look like the real items. Made with Made Snappy 360.

